

## WORKSHOP: "CORK BOARDS"



**Summary:** Participants removed the insides and cleaned up old picture frames, repurposing them into cork boards with paint, embellishments, yarns and d-ring hangers. Buttons and found objects were attached to flat head cork pins and used to hang cork board items.

### Materials and Equipment:

second hand wood frame	pencil, eraser, sharpener
sludge primer	ruler and/or measuring tape
acrylic paints assorted colours	sketch book
paint pen (previous kit)	paint brushes assorted sizes
gel medium (previous kit)	palette knife
sand	foam brush
sheet cork	plastic lids for palettes
cutting mat and x-acto knife	plastic container for water
spacer board (if needed to fill frame rabbit space)	glue gun and glue
wood backing board	cardboard for under glue gun
small screws or frame darts	coated gloves for working with hot glue
tiny clothes pegs	glue
coloured yarn	2x d-ring hangers with matching screws
flat head cork pins	picture frame wire, 20 lb max
buttons or other object for cork pin heads	pliers/cutters
masking tape	safety glasses
scissors	optional: hair dryer with a cool setting (not provided)
screw driver	optional: found objects (participant's own)
sandpaper coarse and fine	optional: varnish (previous kit)
t-shirt scraps	instructions/ideas sheet
picture hooks and nails	industrial felt scraps

### Class Plan:

1. Select a frame you like.
  - a. Frames provided should not have a hard plastic type finish.
  - b. Ideal choices are wood that can be sanded easily, without a hard surface coating.
2. Cover your table surface with a towel and place your frame face down on it.

3. Wearing protective gloves, remove the insides of your frame including glass, picture and mat boards. Place the glass and paper materials in separate bins for recycling.



4. Wearing safety glasses and working with lots of space around you, remove the nails and staples from the back of your frame with pliers levering gently against the back of the frame. A flat head screw driver also works well.
5. Lightly sand your frame if needed to remove any rough edges.
6. Paint your frame if desired.
  - a. Apply sludge primer to your frame surface first to help with paint adhesion.
  - b. Paint your frame with acrylic paints as you like.



- c. Idea: Put 3 similar tone colours on your plastic lid palette. Scoop some of each on the same brush and apply to your frame. The colours will mix a bit as you apply creating a nice multi-tone effect.
  - d. Idea: Solid paint the frame one colour, then paint designs on top when it is dry such as flowers or geometric designs with areas masked with tape.
  - e. Optional: If your paint isn't thick you can speed up drying using the hair dryer on a cool low setting.
7. Embellish your frame:
  - a. Attach ribbons and embellishments to match your theme ideally using either gel medium spread thinly on the back of your fabrics/papers or using hot glue.
  - b. Found objects can be attached with wood glue or hot glue.
  - c. Optional: Varnish the surface of your frame.
8. Making cork board push pins:
  - a. Gather small found objects or old buttons to use as the decorative tops of your cork board pins.

- b. Apply a small amount of hot glue to the back of your object/button. Avoid long thin strings of hot glue by moving your glue gun in a circular motion after applying glue. Wearing protective gloves is recommended.
- c. Pick up a thumb tack with a pair of pliers and push it into the hot glue on the back of your button.



9. Cut your cork to fit sit in the inner space of your frame. It needs to be large enough to sit in the small ledge on the reverse side of your frame (the rabbet). The cork must be larger than the opening in the frame so that it doesn't fall through.



- a. To cut your cork, score it with an x-acto knife onto a board or self-healing mat to protect your work surface. Mark where you want to cut the cork and run the knife carefully along the edge of a metal ruler. Be sure your fingers don't overhang the edge of the ruler when cutting and always close the knife cover before putting it down.



- b. Bend your cork along the score line to snap it apart.



- c. If you have several layers of cork, cut them to size checking the frame shape to see if each layer needs to be slightly larger.
  - d. If you have more than one layer of cork, the smallest piece goes in the frame first.
10. Optional: Apply glue to the back of your backing board with a palette knife. Line up your sheet(s) of cork and press it into place centred on your (smallest if you have more than one) backing board. If your backing board is larger than your cork, apply the glue to the back of the cork and centre it on the backing board.



11. Place your cork and backing board into your frame space and secure it in place:
- a. Place your frame face down on a soft towel on a level surface.
  - b. If you have more than one piece of backing board, put the smallest in your frame first, working to the largest.



- c. If your frame has frame darts in it, bend them flat to hold the board in place.
- d. If your frame has screws, fasten the largest backing board to the frame with a screwdriver running the screws through the backing board into the back edges of the frame. Check alignment so that your screws don't go through a thin section of your frame and show on the front.



12. Optional Alternative: You can add yarns going across your board to hang photos with clothes pegs, instead of adding your cork board.
- a. Lay out where you'd like your photos to hang in the space. Lay yarn lines across the tops and mark on the inside edge of the frame where the lines meet the frame edge. Label the top of your frame on the back so it doesn't get confusing.



- b. Place your frame face down on a towel on your table.
- c. Attach nails or d-ring hangers at each yarn attachment point on the back of the frame. Check the length of your screws against the thickness of your frame, to make sure the screws don't go through on the front side of your frame. Hot glue also works if you don't have nails.
- d. If using d-rings, push firmly on the screw with the screw driver and twist the screw into the wood. Most frames do not need pre-drilled holes.





- e. Tie yarn between the d-rings spanning the width of your frame. Leave yarn ends hanging for decoration or trim short to hide them.
  - f. Use clothes pegs to clip your photographs to the support yarns.
13. Optional Alternative: If you are using yarn and clothes pegs instead of cork and push pins, you can embellish your wood clothes pegs along a theme or to match/contrast with your frame.
- a. Clothes pegs come apart very easily with a twist of the wood in the spring.
  - b. Paint your wood clothes pegs solid colours and/or with patterns all different or matching sets.
  - c. Glue on embellishment objects or smaller wood shapes if available.
  - d. Reassemble your clothes pegs when the paint has dried by twisting the wood pieces back into the spring clip.



14. Attach 2 d-ring picture hangers to the back edges of your cork board frame no more than 1/3 of the way down on each side.

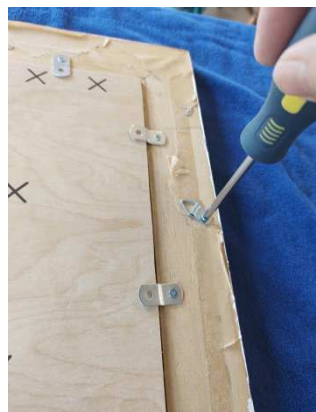

15. Add wire to your d-ring picture hangers:
- a. Feed about 2 inches of your wire through one of the d-rings, fold it back on itself looping behind the other end of the wire. Go back through the same d-ring hole and then twist the two ends of wire

together.

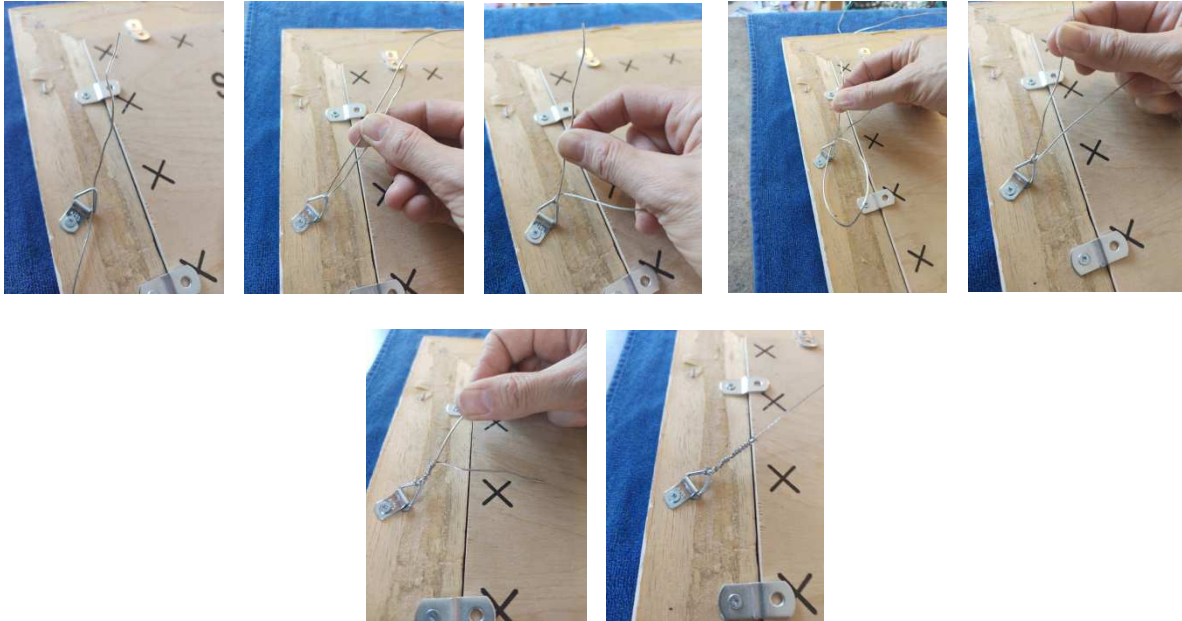

- b. Repeat this step for the other wire.
- c. Test the length of wire to ensure that it won't show above the frame when hung on the wall.



- 16. Glue small pieces of industrial felt on the back to act as bumpers, protecting your wall from scratches. Separate the felt pieces into thinner layers if the felt is too thick for your frame.

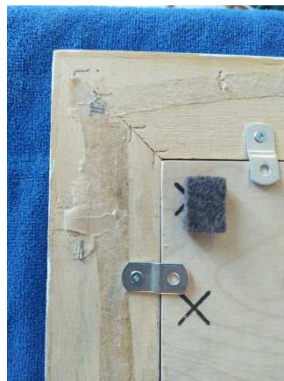

17. Hang your cork board on the wall and change out the photographs periodically. Hang up magazine clippings, reminder notes or anything that might inspire your creativity with or instead of your photos. Even hanging bits of fabric for things you plan to sew can be fun.

**Useful Information/Adaptions/Variations:**

- With digital photos, it has become less common for people to display pictures. This is a fun way to share all different photos on an ongoing basis.
- Screw or nail clothes pegs into the edges of your frame instead of using yarn. Have the clothes pegs point outside of the frame space to add display space and use different size pegs for interest.



- Instead of using cork you could pre-paint/decorate a backing board and attach it in the frame space instead, after stringing yarns across the space for pegging up pictures.

**Trouble Shooting:**

- If your objects come off of your thumb tack pins, try roughening the back of your object with coarse sandpaper and then re-gluing.
- If the paint does not stick well to the surface of the frame, try using a frame that doesn't have a hardened finish on it. The surface of the frame can also be roughened with sandpaper to make the paint adhere better regardless of what is on the surface.
- Paint over any painting work that you aren't happy with the first time.
- For frames with damage like dents on the surface, apply embellishment objects over these spots, or fill them with wood filler in a colour matching your intended paint colours (wood filler colour can sometimes bleed through paint over it).
- If your yarns sag under the weight of the photographs, remove the yarns and tie tighter lengths in place instead.